

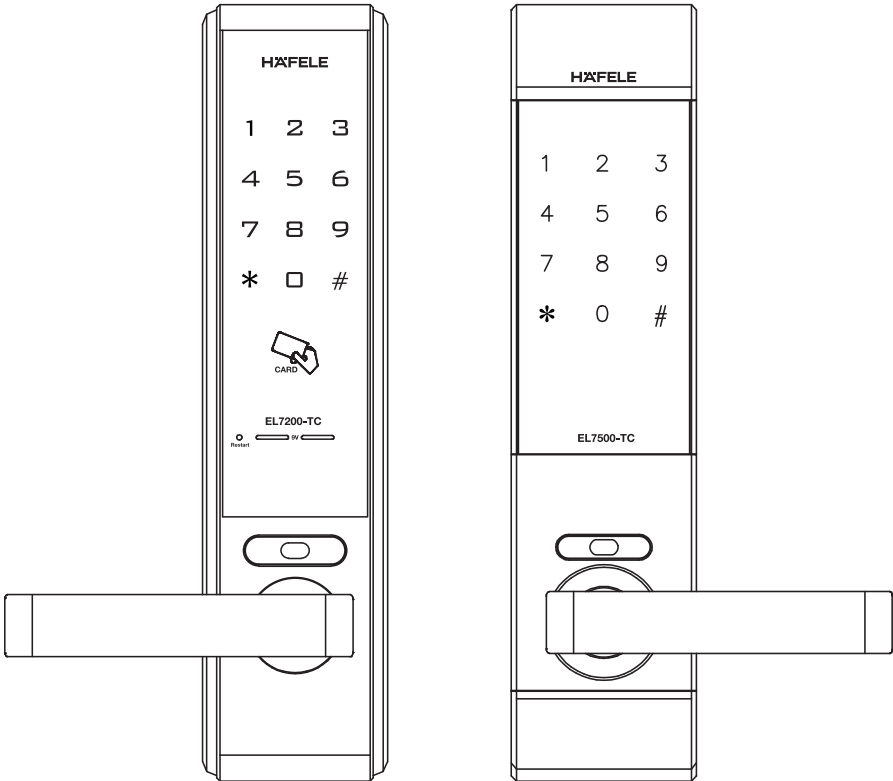

Digital door lock Model EL7200-TC / EL7500-TC



User Manual

Product features



Three way solution

Available to use one solution of Password, Key card / tag as well as key override.



Random security coding function

When you enter your home with friends or other people, you don't want to show secret code to them. In this case, you may press any number randomly without limitation and then enter your secret code at final. Then, you can open the door without revealing your secret code.



Key card / tag or password identification

up to 50 key cards / tags, 1 security code and 1 master code.



Panic Release handle type

It facilitates escapes while in danger opening easily with a simple action of lever down.



High reliance electric mortise lock type

It has high reliability electric mortise lock type with installing the locking device on door body inside.



Auto lock / Auto re-lock function

When the door is closed, to be locked status automatically. And if users do not open the door after unlocking with password, etc, it is to be locked automatically for higher security.



Double lock function (Privacy function)

When double lock system is activated, the door cannot be opened from outside even with the registered card key or secret code.



Trespass alarm function

When the door is opened by force with hammer or other devices, door lock function is suspended with alarm sound.



Prevent mischief and hacking

With 5 times of abnormal try with wrong secret code, function of door lock is suspended 1 minute.



Alarm for battery replacement time

Easy to check battery status with alarming battery replacement time with sound & lamp.

Safety precautions



Do not disassemble or alter the lock. Assembling or disassembling the door lock may damage the product. Damages to the product caused by unauthorized persons may result in damages to your property. Please contact our Customer Service.



If the product generates harmful gases or smoke, please remove the batteries immediately from the product. If you do not take this step immediately, the product may suffer severe damage.



Please keep the product away from water or any liquids. If the product is exposed to salty water or liquids, please wipe off the moisture with a soft cloth. If moisture or foreign materials penetrate the product, remove the batteries immediately and contact the Service Agency or Customer Service Center for advice. Using a product contaminated with foreign materials may cause problems.



Please check the batteries every 6 months to see if the batteries are leaking and to check the cleanliness of battery terminals. If leakage is discovered, please wipe out with a dry cloth and replace the new batteries. In case of exposure to leakage, wash with soap and water immediately.



Do not clean the product with flammable materials such as alcohol, benzene or thinners. Such materials may damage the surface or cause a fire.



Batteries should not be exposed directly to heat sources or flames, or submerged in water, because they may leak or explode, resulting in severe damage. Please do not use damaged batteries.



Do not allow the battery electrodes to make contact with metals such as keys, as the battery may overheat, causing explosion or severe damage.



Please do not close the door with the deadbolt in the locked position. It may damage the product or cause a malfunction.



Do not force to pull the front cover. It may damage the product or cause a malfunction.



Please do not mix old with new batteries or use different types. Always use new alkaline batteries. Please make sure the batteries are inserted correctly (+/-) as indicated in the battery compartment. Otherwise, it may cause a leaks or explosions.



Do not use the product where direct sunlight or high temperature. It may cause malfunction or abnormal operation.



Do not install the product where direct contact with rainwater is possible. The rainwater may cause the malfunction of the product.

Contents

Read before using

Product composition and components	4
Name and function of each part	5
How to know the battery exchange time/replace battery	6
How to apply external power in the emergency	7
How to use mechanical override key	7
How to use touch-pad and random security coding function	8
How to change mode (Normal mode ➔ Safety mode)	9
How to change mode (Safety mode ➔ Normal mode)	9
Normal Mode	10
How to register secret code in normal mode	10
How to register card key / tag in normal mode	10
How to delete all card key / tag in normal mode	11
Safety mode	12
How to register secret code (in safety mode)	12
How to register key card / tag in safety mode	13
How to delete all key card / tag in safety mode	14

Basic function

How to open from outdoor (secret code, card / tag, mute function)	15
How to lock from outdoor	16
How to open from indoor	17
How to lock from indoor	17

Applications

How to open / close with  button from indoor	18
How to open / close with thumbturn from indoor. (EL7500-TC)	18
How to set double locking function	19
Auto-locking system	20
Auto-relocking system	20
How to set auto/manual locking system	21
How to control volume level	22
Warning function against abnormal locking	22
Warning function against mischief or hacking	23
Warning alarm function against trespassing by force	23
Restart function (EL7200-TC only)	24
Fire sensing function (built-in fire detection sensor)	24
External alarm function	24
Fault diagnosis and troubleshooting	25
Product specifications	25

Product composition and components

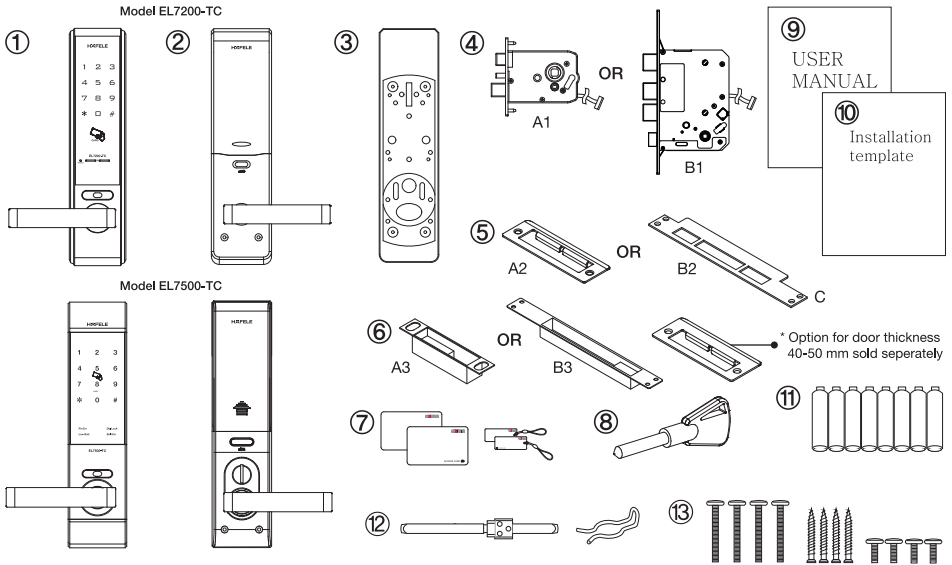

Name	Product specification		Remark
	EL7200-TC	EL7500-TC	
1. External module (WxHxD)	77 x 305 x 24 mm	78 x 307 x 26 mm	Including rubber pad
2. Internal module (WxHxD)	79 x 305 x 34 mm	79 x 311 x 35 mm	
3. Back plate (WxHxD)	78 x 310 x 7.9 mm	80 x 312 x 7.9 mm	Including rubber pad
4. Mortise lock (WxHxD)	A1 : 123 x 110 x 25 mm or B1 : 240 x 110 x 25 mm		
5. Striking plate (WxHxTHK)	A2 : 35 x 106 x 1.5 mm or B2 : 240 x 42 x 2 mm		A2 : Standard for door thickness 35-40 mm ; B2 : 35-50 mm
	C : 42 x 106 x 1.5 mm		C : Option for door thickness 40-50 mm used with mortise lock A1
6. Striker box (WxHxD)	A3 : 24 x 102 x 18 mm or B3 : 24 x 236 x 18 mm		
7. Key card / Tag (W x L)	54 x 85 mm 2EA / 18 x 45 mm 2EA		
8. Mechanical key	3EA		
9. User manual	Main user manual		
10. Installation template	Use for making hole at the door		
11. Battery	8 EA (1.5V, 'AA' Size, LR6 Alkaline)		
12. Handle shaft	90 (L) x □8 x 8 / □6 x 6 mm with locking ring		
13. Screw set	4 x 6 mm 4EA ; For back plate / internal module	4 x 8 mm 4EA ; For back plate / internal module	BH M4 x 6 or M4 x 8 BH M5 x 30 FH #10-24 x 10
	5 x 30 mm 4EA : For external module / back plate #10-24 x 10 mm 4EA : For mortise lock and striking plate		

✓ Name and function of each part

External module

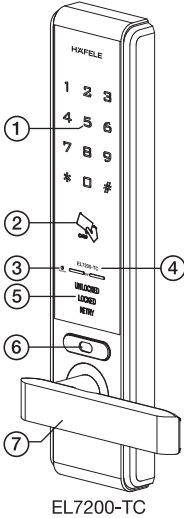

EL7200-TC

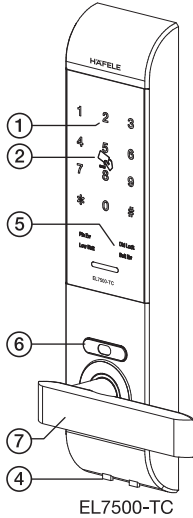

EL7500-TC

- ① **Numeric touch screen**
Input secret code for opening door.
- ② **Key card / tag touch area**
Touch the register key card / tag key to open the door.
- ③ **Restart button**
To restart program. In case of temporary error rather than product malfunction.
- ④ **External power supply terminal**
When the battery is entirely exhausted, please contact 9V battery(6LF22) to emergency power terminal.
- ⑤ **External alarm indicator**
Show warning and enable special function.
- ⑥ **Emergency key hole**
Open the door with mechanical key by manual.
- ⑦ **Handle**
Open the door by pulling down it after the pressing secret code or touching key card / tag.

Internal module

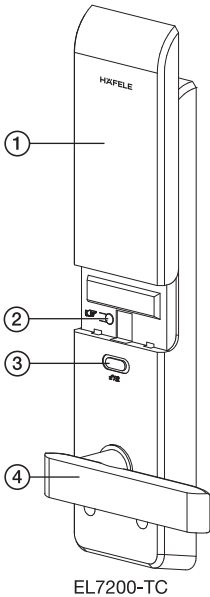

EL7200-TC

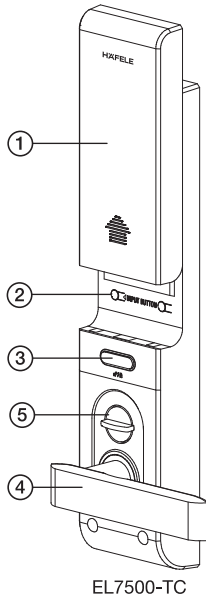

EL7500-TC

- ① **Battery cover**
Slide up to open the battery cover.
- ② **Input button** (👉)
Register or delete the secret code or key card / tag.
- ③ **Open / Close button** (🔓/🔒)
Use Open / Close button to open or close the door in the room.
- ④ **Handle**
Can open the door at anytimes only by pulling down it.
- ⑤ **Manual opening and closing knob**
Open / Close the door manually, in case of emergency or the battery entire exhaust.

⚠ Note



Remove the protection film on the touch screen after install the digital door lock.

✓ How to know the battery exchange time / replace battery

♪Di-Di-Dee-Dee- Di-Di-Dee.....		
1	2	3
4	5	6
7	8	9
*	0	#

When the battery voltage gets down, it's the battery exchange time. The saved melody ring comes out every locked and unlocked time.

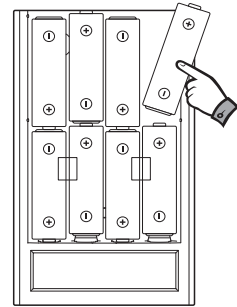
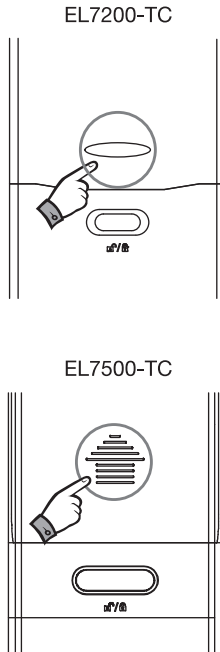

Replace all 8 batteries to new one in same position as like above picture.

Separate battery cover by pushing to upper direction arrow direction as pressing line mark (EL7200-TC) or arrow mark (EL7500-TC) by finger.

ⓘ Note

- Life of battery is around one year based on 20 times of uses a day.
- Battery life can be vary depending on battery's manufacturer, production date, installed environment and usage frequency.
- Second hand battery or usage of different type batteries can be a reason of door lock's malfunction.
- Do not use rechargeable battery.
- Leakage on battery can be caused and it is very harmful for door lock's operation. Please check batteries periodically (at least every 6 months) and if there is any of leakage on battery, replace all to new batteries.
- EL7500-TC also has the low battery alarm on outdoor [Low Batt] lamp light up when it is the battery exchange time.
- When the low battery alarm is occurred, please replace the battery as soon as possible.

✓ How to apply external power in the emergency

When the battery is entirely exhausted and door lock is not activated, please contact 9V (6LF22) battery to emergency power terminal. Once the door lock is activated, open the door by secret code or key card and replace the batteries in internal module.

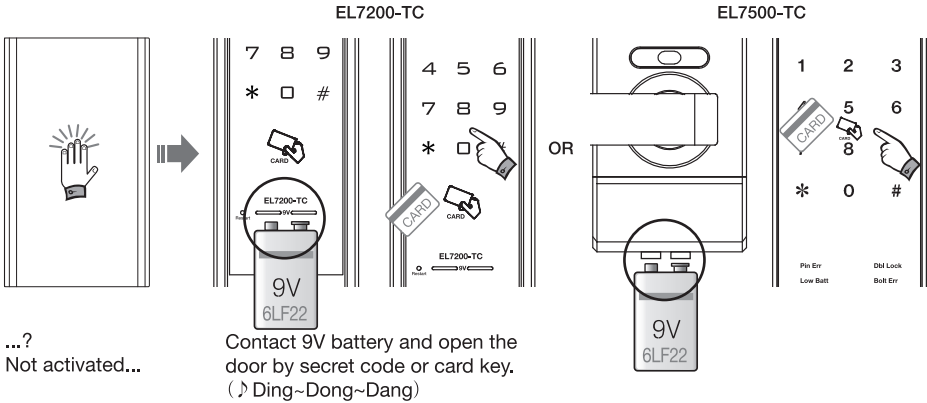

✓ How to use mechanical override key

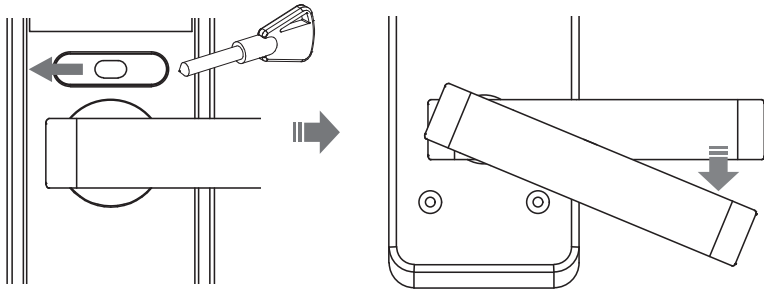

Slide the cover with finger to arrow direction. Insert key and keep turning status

Pull down the handle and open the door

! Note

- Position of polarity is in regardless.
- Please keep mechanical override key separately for usage in the emergency.
- After using mechanical override key, please store it safely.

✓ How to use touch-pad and random security coding function

Random security coding function - Press any number randomly without limitation and then enter your secret code at final. With this function, you can open the door without revealing your secret code to others.

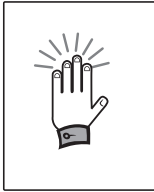

Touch the front pad

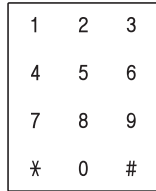

Numeric buttons are displayed

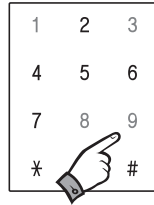

Press random code (Ex : 1389)
Press secret code (Ex : 1234) and [*].
Pull down the handle, then door is opened.

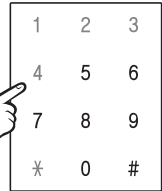

⚠ Note

- Do not wear gloves during operation for touch pad.
- When you use random security coding function, actual secret code shall be entered at final.
- Please use soft cloth when you clean touch pad

✓ How to change mode (Normal mode → Safety mode)

⚠ On safety mode manager code is required when change secret code or register / delete key cards and key tags

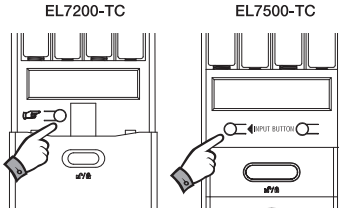

Open battery cover. Press [] button (EL7200-TC) or [INPUT BUTTON] button (EL7500-TC) (one short beep sound)

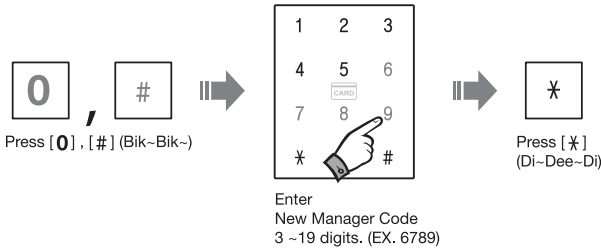

ⓘ Note

- Manager code shall be controlled by authorized person for security.
- Manager code can be used to unlock the door like the same way of secret code.
- Only one of manager code can be registered with 3 ~ 19 digits.
- Only one of Secret code can be registered with 3 ~19 digits.
- Previous code is deleted automatically with registration of new code.
- Please do the change / registration of new code at door opened status to prevent unintentional locking.
- After changing secret code, please verify it by unlocking with new secret code.
- When [] button (EL7200-TC) or [INPUT BUTTON] button (EL7500-TC) is pressed, it always make one short beep sound and two short beep sound for normal mode and safety mode respectively.

✓ How to change mode (Safety mode → Normal mode)

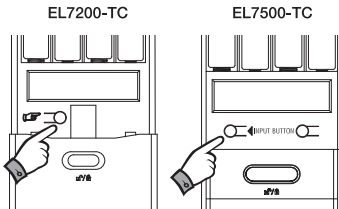

Open battery cover. Press [] button (EL7200-TC) or [INPUT BUTTON] button (EL7500-TC) (two short beep sound)

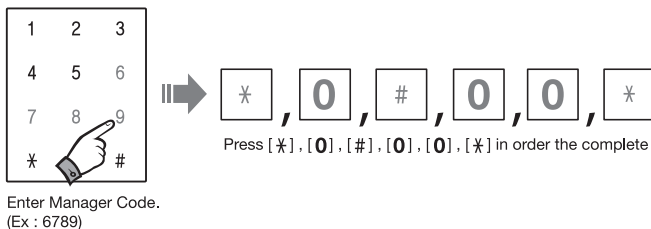

How to register secret code in normal mode

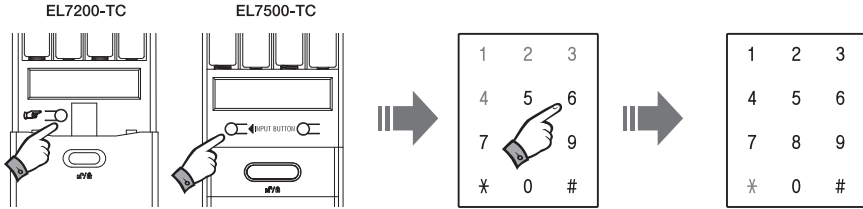

Open battery cover and press [] button (EL7200-TC) or [INPUT BUTTON] button (EL7500-TC) shortly (one short beep sound)

Press new secret code. (3~19 digits) (Ex : 1234)

Press [*], then new code is registered with (Di-Dee-Dee) sound.

Note

- Factory setting (Mode : Normal mode, Secret code : 1234)
- Only one of Secret code can be registered with 3 to 19 digits.
- Previous code is deleted automatically with registration of new code.
- Please do the change/registration of new code at door opened status to prevent unintentional locking.
- After changing secret code, please verify it by unlocking with new secret code.

How to register key card / tag in normal mode

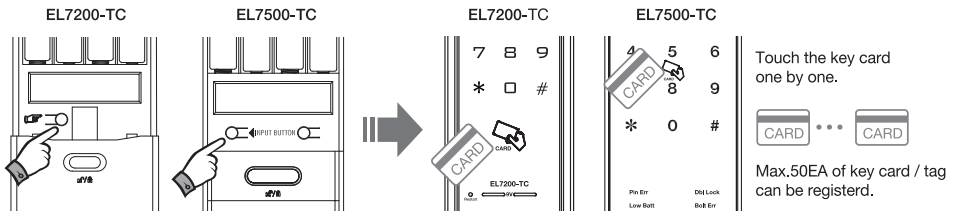



Open battery cover and press [] button (EL7200-TC) or [INPUT BUTTON] button (EL7500-TC) shortly (one short beep sound)

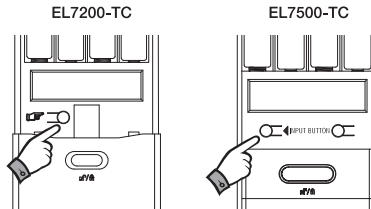

Complete registration by [*]

✓ How to delete all key card / tag in normal mode



Open the battery cover and press [] button (EL7200-TC) or [INPUT BUTTON] button (EL7500-TC) shortly (one short beep sound)

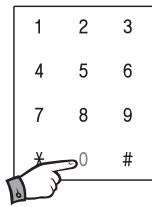

Press [0] 2 times

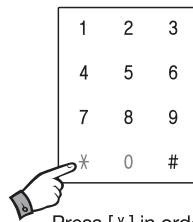

Press [*] in order the complete

⚠ Note

- Previous card key / tag memory is not deleted automatically after registration of new card / tag.
- Max. 50 key cards / tags can be registered.
- For high security, please use cards which are supplied by HAFELE.

How to register secret code in safety mode

⚠ Manager code shall be controlled by authorized person for security.

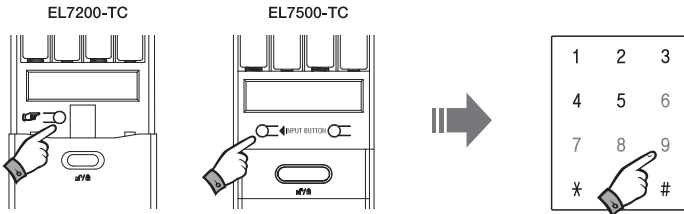

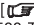
Open the battery cover and press [] button (EL7200-TC) or [INPUT BUTTON] button (EL7500-TC) button shortly (two short beep sound)

Registered manager code 3~19 digits. (EX.6789)

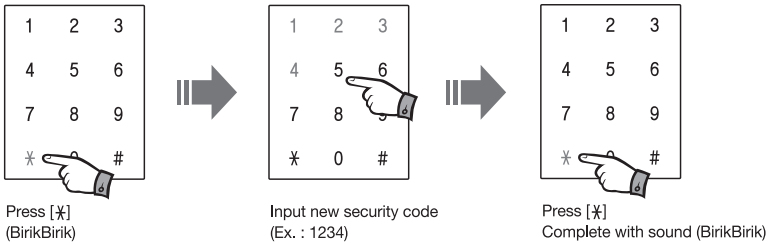

Note

- Only one of secret code can be registered with 3 to 19 digits.
- Previous code is deleted automatically with registration of new code.
- Please do the change/registration of new code at door opened status to prevent unintentional locking.
- After changing secret code, please verify it by unlocking with new secret code.

How to register key card / tag in safety mode

EL7200-TC

EL7500-TC

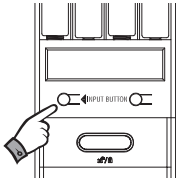
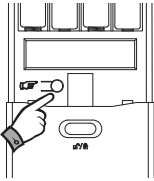

Open the battery cover and press [] button (EL7200-TC) or [INPUT BUTTON] button (EL7500-TC) shortly (two short beep sound)

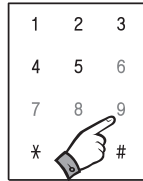

Enter manager code
(Ex : 6789)

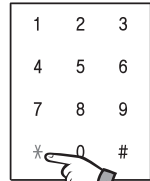

Press [*]

EL7200-TC

EL7500-TC

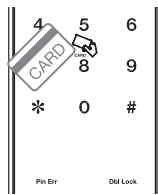
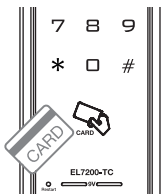

Touch key card / tag



To register more key card / tag

(Max.50EA of key card / tag can be registerd)

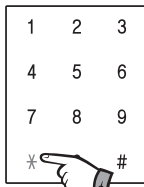

Press [*]
Complete with
sound (BirikBirik)

Note

- Please use and register only key card / tag by HAFELE.

✓ How to delete all key card / tag in safety mode

⚠ When the key cards and key tags are deleted, existing registered key card and key tag are completely deleted. Then, newly register key card and key tag to be used.

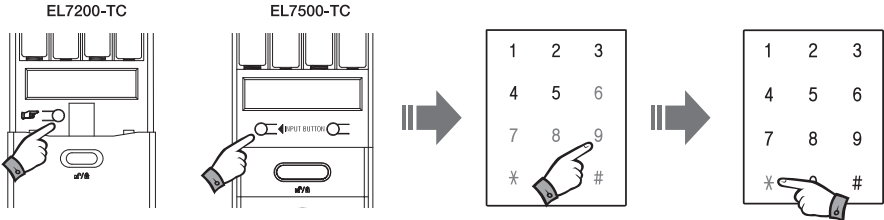

Open the battery cover and press [] button (EL7200-TC) or [INPUT BUTTON] button (EL7500-TC) shortly (two short beep sound)

Enter manager code (Ex : 6789)

Press [*]

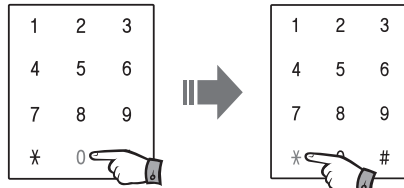

Press [0] 2 times

Press [*]

How to open from outdoor (Secret code, card / tag, Mute function)

1. Open the door using secret code

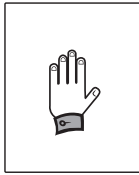

Touch the front pad

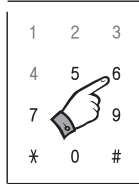

Enter secret code
(Ex : 1234)

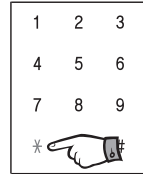

Press [*] and door
is unlocked (Di-Dee-Dee)

2. Open the door using key card

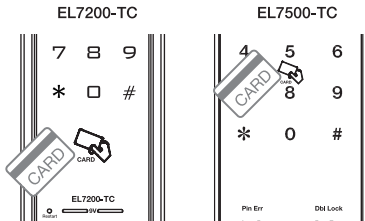

1) Touch the registered card key
to card contact point
“Di-Dee-Dee” Sound occurred.

2) Pull down the handle and
open the door.

3. Open the door with mute function (No sound)

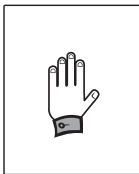

Touch the front pad

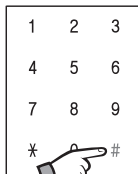

Press [#]

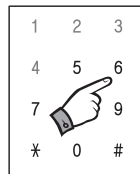

Enter secret code
(Ex : 1234)

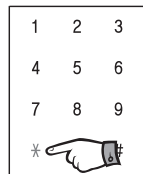

Press [*] and door
is unlocked

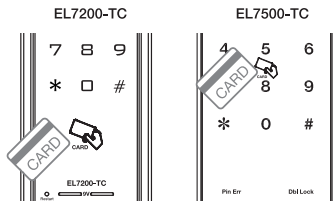

Touch the card



Pull down the handle
and open the door

Note

- Mute mode is sustained for 1 unlocking time.
- With applying wrong code for 5 times, the digital door lock does not work for 1 minute. However the registered card / tag or mechanical key can open the door.
When the digital door lock has not work, you should use it in 1 minute.

✓ How to lock from outdoor

1. Lock the door at auto-locking mode

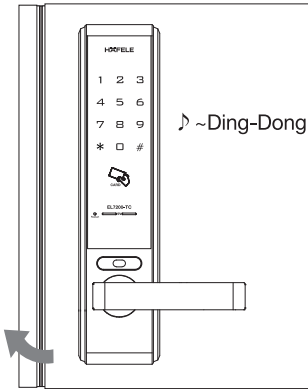

EL7200-TC

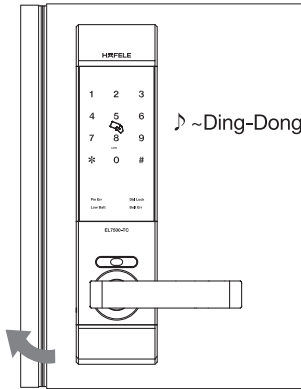

EL7500-TC

When the door is closed, It is locked automatically. (Ding-Dong)

2. Lock door at manual-locking mode

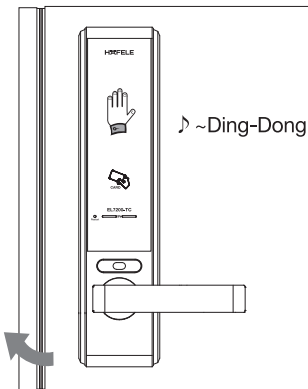

EL7200-TC

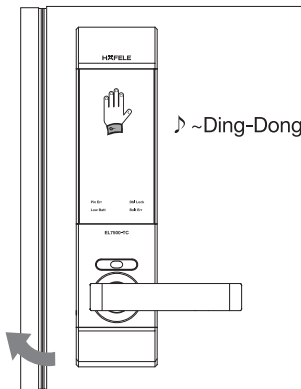

EL7500-TC

Close door and touch the front pad then press [#] door will be locked.

*At manual-locking mode, door is not locked automatically even though the door is closed.

! Note

- If the door is not closed correctly, warning sound can be caused. Please check and confirm the door closing status.
- Please confirm that the door is properly closed by pulling down the handle.

Basic function

✓ How to open from indoor

EL7200-TC

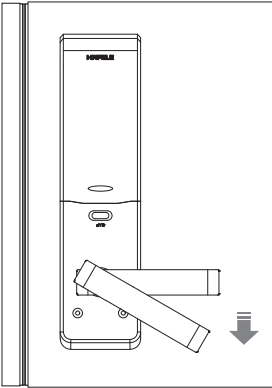

EL7500-TC

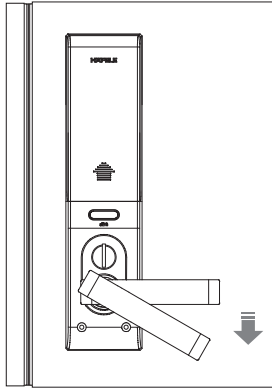

PANIC RELEASE TYPE

Just pulling down the handle, door lock is opened at anytime.

What's "PANIC RELEASE"?

Door can be opened with simple action of pulling down the handle. Even the door lock is out of order, people can escape easily in the emergency such as fire etc.

✓ How to lock from indoor

1. In auto-locking mode

When the door is closed, door is locked automatically. (Ding-Dong)

EL7200-TC

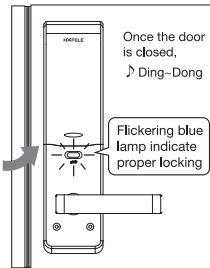

EL7500-TC

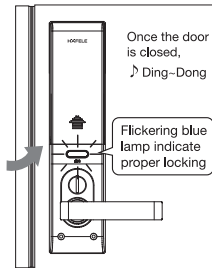

2. Manual-locking mode

After closing door, press  button, then door is locked. (Ding-Dong)

EL7200-TC

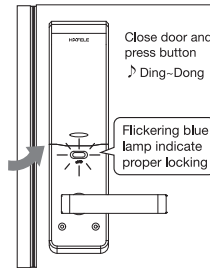

EL7500-TC

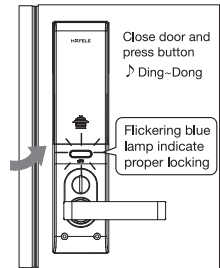

! Note

- Before closing the door, make sure that deadbolt is not extrude.
- If the door is not closed correctly, warning sound can be caused. Please check and confirm the door closing status.

✓ How to open / close with [🔒/🔓] button from indoor

Press while lock status, it will be unlocked
 Press while unlock status, it will be locked
 EL7200-TC

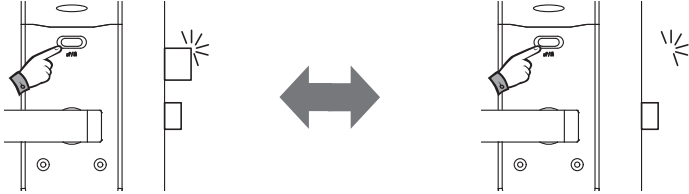

EL7500-TC

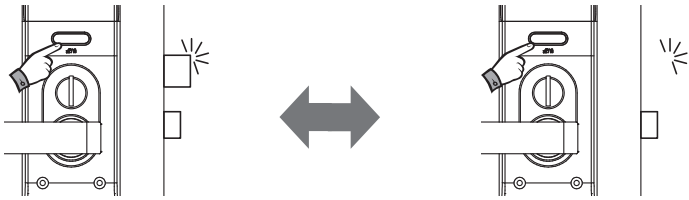

! Note

- [🔒/🔓] is unusable to lock / unlock the door while on double locking mode

✓ How to open / close with thumbturn from indoor (EL7500 only)

Turn thumbturn until I-mark is horizontal, it will be unlocked

Turn thumbturn until I-mark is vertical, it will be locked

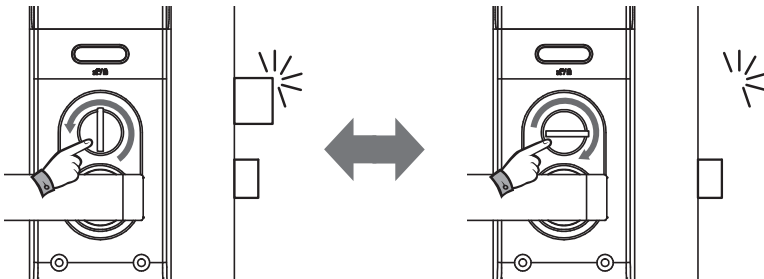

! Note

- While unlocking, the handle on outdoor can open the door as well as the handle on indoor.
- While locking, the handle on indoor can open the door but the handle on outdoor cannot open the door.

✓ How to set double locking function

In [Double lock] mode, function of door lock is suspended and can't open the door from outside.

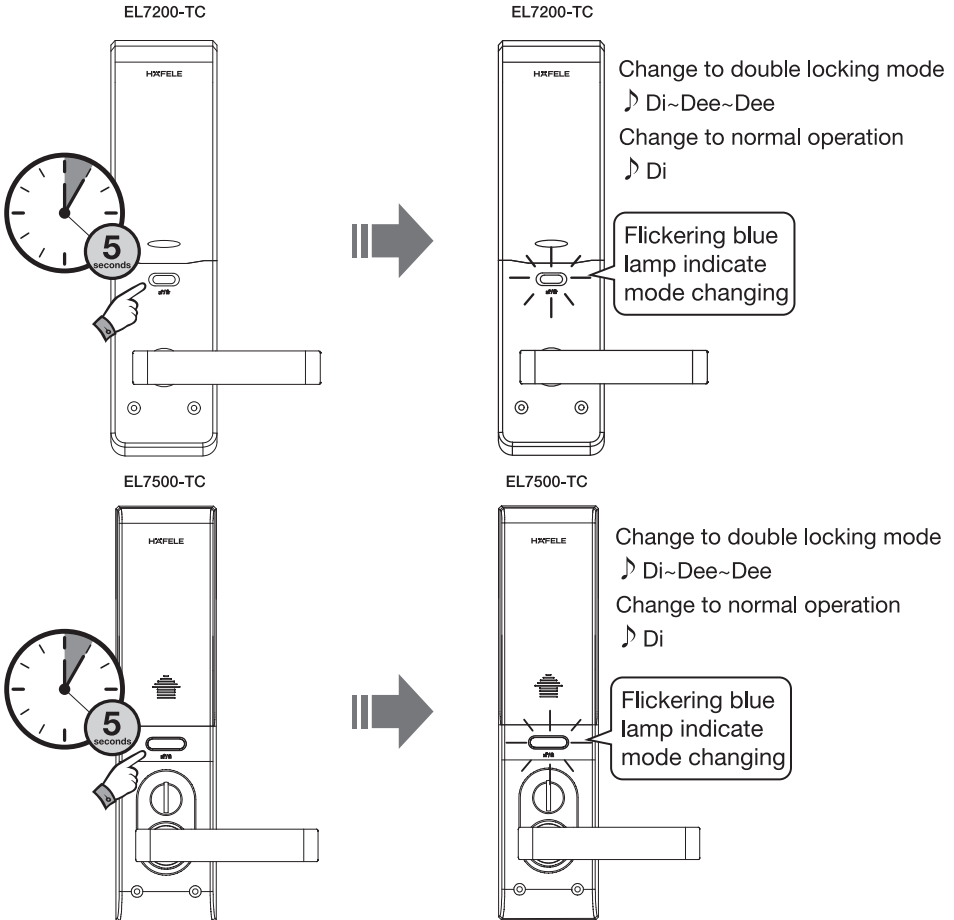

Press [🔒] button more than 5 seconds

Double locking mode and normal operation are alternative.
When lock will be double mode, it sounds Di~Dee~Dee.
When lock will be normal operation, it sound Di

⚠ Note

- [Double locking] mode can be activated after the door is closed only.
- Even in [Double locking] mode, it is available to open the door from indoor by pulling down handle.
=> Panic release system
- With pulling down handle from indoor, [Double locking] mode shall be released automatically.

✓ Auto-locking system

When the door is closed, it will be locked automatically.
(Please refer to next page for setting method.)

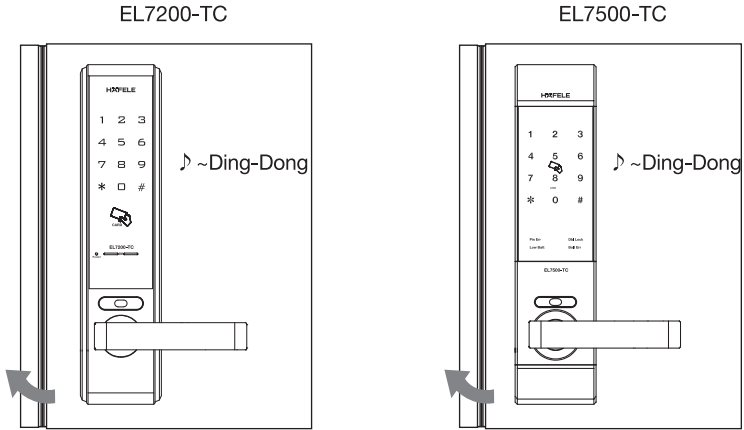

✓ Auto-relocking system

If the door is not opened within 7 seconds after input secret code, key card/tag, it will be relocked automatically to protect user's property.

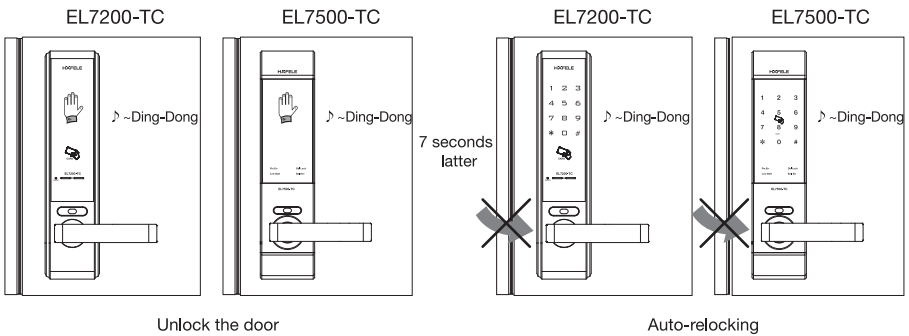

! Note

- Auto-relocking system is different from "Auto-locking".
- This is fixed function and can't be released.

How to set auto/manual locking system

In Auto-locking mode, door will be locked automatically after closing.

In Manual-locking mode, door will be locked with pressing [/] button after closing.

EL7200-TC

EL7500-TC

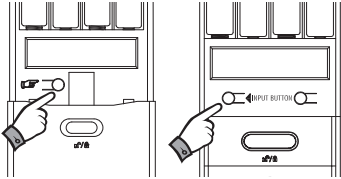

Open the battery cover and press [/] button (EL7200-TC) or [INPUT BUTTON] button (EL7500-TC)

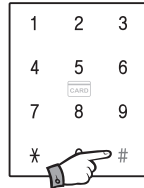

Press [#]

Note

- In case of [Manual lock] mode, to make it unlocked status, door lock shall be opened by secret code, key card / tag or indoor handle.

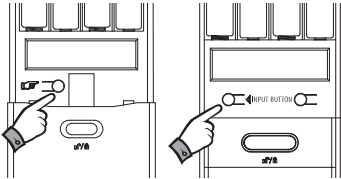

Press [/] button (EL7200-TC) or [INPUT BUTTON] button (EL7500-TC) to confirm

♪ Di-Dee-Dee
(To auto-locking mode)

♪ Beep
(To manual-locking mode)

Auto-locking mode and manual-locking mode are alternated when the setting is complete

How to change auto-locking time

Auto-locking time can be set between 1-9 seconds

EL7200-TC

EL7500-TC

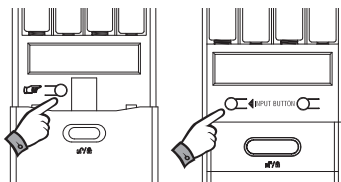

Open the battery cover and press [/] button (EL7200-TC) or [INPUT BUTTON] button (EL7500-TC)



Press [8]

1 OR **2** OR **3** OR **4** ... OR **9**

Input number as desired time (1-9 seconds)



♪ Di-Dee-Dee

Press [*] complete with sound (Di-Dee-Dee)

✓ How to control volume level

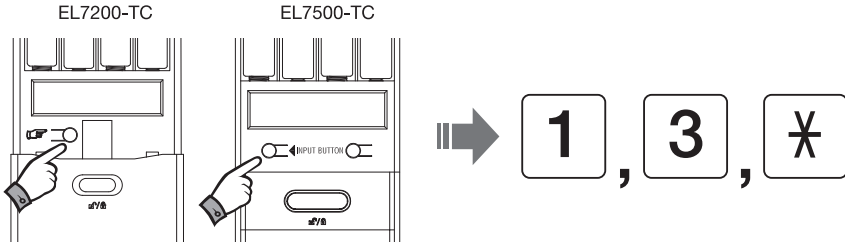

Open the battery cover and press [] button (EL7200-TC) or [INPUT BUTTON] button (EL7500-TC)

Press [1], [3] and [*] in order to control volume level (Di~Dee~Dee)



1 : Volume down
3 : Volume up

Press [*] complete with sound (Di~Dee~Dee)

✓ Warning function against abnormal locking

When the door is not closed normally such as deadbolt is struck in the striking plate, the lock will try to open the door 3 times and then “Beep” sound will occur to inform you of an error.

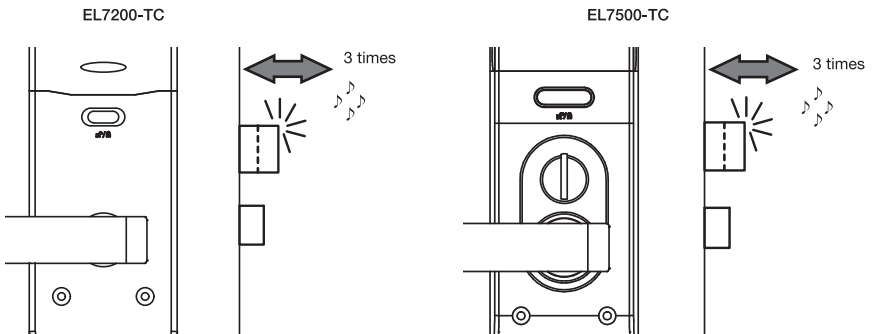

! Note

- EL7500-TC also has warning function against abnormal locking on outdoor. If [Bolt Err] lamp light up, open/close function is not working properly since deadbolt is stuck in the striking plate

Warning function against mischief or hacking



Applying wrong secret code over 5 times



After alarm sound, system is suspended for 1 minutes

Warning alarm function against trespassing by force

If there is any trying of trespassing by force, it is warning with strong alarm sound for 1 minutes.

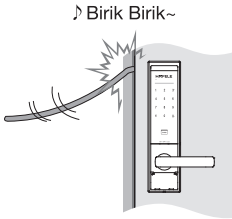

How to release warning sound

1. Touch the key card / tag



or

2. Input secret code

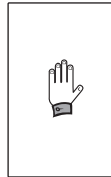

Touch the front pad



Input secret code (Ex : 1234)



Press [*]
Warning sound will be stop

Note

- With applying wrong code for 5 times the digital door lock does not work for minute. When the digital door lock has not work you should use it in 1 minute.
- In case warning function against mischief/hacking is activated, it will be released after 1 minutes.
- Trespass warning alarm continues for 1 minutes.
- If the trespass warning alarm is released by secret code or key card / tag, system return to normal status.

✓ Restart function (EL7200-TC only)

It's used for program restarting by pressing reset button in case of temporary error rather than product malfunction

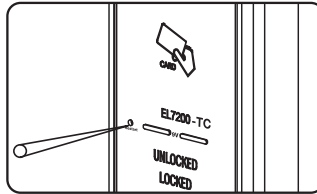

ⓘ Note

- All secret code and key cards / tags aren't deleted.

✓ Fire sensing function (built-in fire detection sensor)

When the thermal detection sensors heat ($60^{\circ}\text{C} \pm 10^{\circ}\text{C}$), the door will be automatically opened.

✓ External alarm function

EL7200-TC

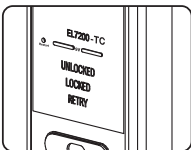

- "Lock" lamp light up when the door is changed from unlock to lock status
- "Unlock" lamp light up when the door is unlocked by password, secret card / tag or indoor handle
- "Retry" lamp light up when entering invalid password. Enter correct password again.

EL7500-TC

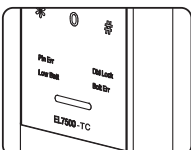

- External "Pin Err" lamp light up when entering invalid password. Enter correct password again.
- "Low Batt" lamp flashes, when batteries are going flat. Immediately change all of 8 batteries.
- When "Dbl lock" lamp light up a door will not open even after entering correct password. (Dual locking function is enabled).
- If "Bolt Err" lamp light up open/close function is not working properly since dead bolt (Latch) of indoor body is stuck in striking plate.

✔ Fault diagnosis and troubleshooting

Symptoms	Troubleshooting
Cannot remember password	Open a door using key card / tag and register new password
Password input failure (5 attempts)	All functions are not available for 1 minute after failure of 5th attempt. Wait for 1 minute and set new password or key card / tag
Door is not automatically locked	Check if auto locking function is enabled
Button is not working	If other functions are not working, check if batteries are properly inserted. If batteries are flat, replace them with new batteries.
External button sound is not working and lamp is not flashing	Check if there is any liquid leakage on battery case or product and if so, wipe out contact area with a dry cloth.

✔ Product specifications

Type	Specification	
Basic items	Password	1 manager password and 1 user password (3-19 digits)
	The number of key cards/ tags to be registered	Up to 50 cards / tags
	Thickness of door	35-50 mm
Power supply	Power source	AA Size 1.5V Alkaline Battery X 8EA
	Emergency power source (Do not have polarity)	9V square alkaline battery (Purchase separately)